



## Custom Dynamics® Saddlebag Grommet Installation Instructions

We thank you for purchasing the Custom Dynamics® SaddleBag Grommets. Our products utilize the latest technology and high quality components to ensure you the most reliable service. We offer one of the best warranty programs in the industry and we back our products with excellent customer support, if you have questions before or during installation of this product please call Custom Dynamics® at 1(800) 382-1388.

**Part Numbers:** GROMMET-13 GROMMET-DC  
GROMMET-14

**Package Contents:**

- Grommet (2)

**GROMMET-13 FITMENT:**

2013-Earlier OEM Harley-Davidson® Saddle Bags with 1/8" Thickness.

**GROMMET-14 FITMENT:**

2014-Current OEM Harley-Davidson® Saddle Bags with 1/4" Thickness.

**GROMMET-DC FITMENT:**

2014-Current OEM Harley-Davidson® Saddle Bags with 1/4" Thickness.



**Installation:**

1. Determine grommet location.
2. Drill 9/16" hole at the determined grommet location.
3. Insert the grommet into the pre-drilled 9/16" hole in Step 2.
4. Pull wire harness through grommet.

**Specifications:**

**Grommet-13**

For Hole Diameter (A) 9/16"  
 For Material Thickness (B) 1/8"  
 ID (C) 1/8"  
 Flange Diameter (D) 3/4"  
 Overall Height (E) 1/4"

**Grommet-14**

For Hole Diameter (A) 9/16"  
 For Material Thickness (B) 1/4"  
 ID (C) 1/8"  
 Flange Diameter (D) 3/4"  
 Overall Height (E) 3/8"

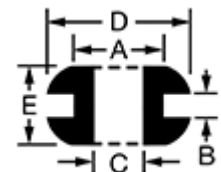

**Grommet-DC**

For Hole Diameter (A) 9/16"  
 For Material Thickness (B) 1/4"  
 ID (C) 3/16"  
 Flange Diameter (D) 3/4"  
 Overall Height (E) 3/8"



# ATTENTION

Please read all Information below before Installation

**Warning:** Disconnect negative battery cable from battery; refer to owner's manual. Failure to do so may result in electrical shock, injury, or fire. Secure negative battery cable away from positive side of battery and all other positive voltage sources on vehicle.

**Safety First:** Always wear appropriate safety gear including safety glasses when performing any electrical work. It is highly recommended that safety glasses be worn throughout this installation process. Be sure vehicle is on level surface, secure and cool.

Questions? Call us at: 1 (800) 382-1388 M-TH 8:30AM-5:30PM / FR 9:30AM-5:30PM EST