



Custom Dynamics®
ProBEAM® Bullet Bezel Turn Signals
Installation Instructions

We thank you for purchasing the Custom Dynamics® ProBEAM® Bullet Bezel Turn Signals! Our LEDs offer maintenance free service and higher visibility. Our ProBEAM® product line utilizes the latest technology and automotive grade components to ensure the highest level of reliable service. Custom Dynamics® offers one of the best warranty programs and customer support in the industry. If you have any questions during the installation of this product please call us at 1(800) 382-1388.

Part Number: PB-BB-AW-JAECS, PB-BB-AW-JAEBS

US Patent 830597, 830595
Chinese Patent ZL201830045649.4, Other Patent Pending



Package Contents:

- ProBEAM® Bullet Bezel Turn Signals (1 pair)
- Instructions

Fitment: 2016-2019 Harley-Davidson® Street Glide CVO™, Limited CVO™, 2016 Road Glide Ultra CVO™, 2018-2019 Road Glide CVO™ & 2016-2017 Pro Street Breakout CVO™.



Please read all information below before installation

Note:

- Use care in removing the OEM lens and bulbs or LED from the housing, so as not to scratch or mar the chrome housing. Custom Dynamics® is not liable for damage to chrome housing during installation.

*****IMPORTANT*****

This LED product is BCM compliant. However, you must run the 4 way hazard flashers for 3 minutes with the ignition in the OFF position to allow the BCM to sync the new LED turn signals after they are installed.



Questions? Call us at: 1 (800) 382-1388 M-TH 8:30AM-5:30PM / FR 9:30AM-5:30PM EST

Installation Instructions - Page 2

Installation:

1. Remove the existing lens from turn signal housing.
2. Gently pry the existing LED turn signal and black gasket out of the turn signal housing with a small screw driver around the perimeter of the turn signal to remove it as shown in Picture 1. Try to get in behind the black gasket while doing this . Once you have enough of the existing LED turn signal out of the housing, pull it free with your fingers. Use caution when doing this as the wiring is still attached behind the existing LED turn signal.

NOTE: On 2016 Road Glide Ultra CVO™ and 2018 Road Glide CVO™ models it may be necessary to remove the front fairing to provide slack in the turn signal housing wiring.

3. Locate the tab on the end of the wire connector, push in and disconnect the connector from the stock LED turn signal as shown in Picture 2.
4. Plug the Bullet Bezel LED turn signal into connector making sure they snap together as shown in Picture 3. You should hear a “Click” when fully connected.
5. Twist the Bullet Bezel LED turn signal a few rotations to coil wire from the turn signal to the socket base. Insert the Bullet Bezel Turn Signal into the turn signal housing. Push and snap the Bullet Bezel Turn Signal into the turn signal housing.
6. Run the 4 way hazard flashers for 3 minutes with the ignition in the OFF position to allow the BCM to sync the new Bullet Bezel LED turn signals after they are installed.
7. Check operation of all turn signals in all modes.

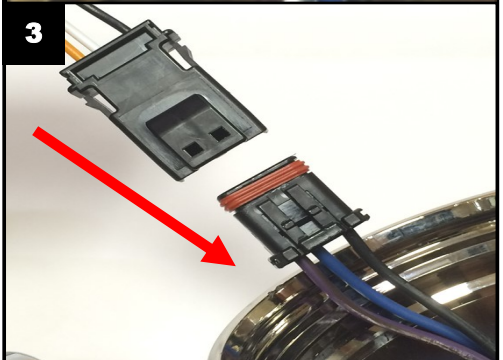
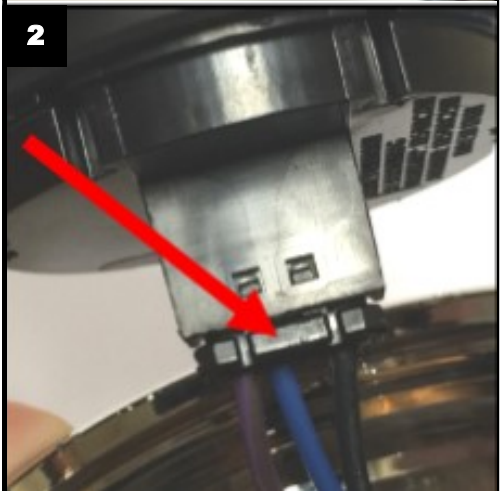

PROBEAM
BY CUSTOM DYNAMICS®