



Custom Dynamics® MAGIC Tour-Pak® Converter Harness Installation Instructions

We thank you for purchasing the Custom Dynamics® MAGIC Tour-Pak® Converter. Our products utilize the latest technology and high quality components to ensure you the most reliable service. We offer one of the best warranty programs in the industry and we back our products with excellent customer support, if you have questions before or during installation of this product please call Custom Dynamics® at 1(800) 382-1388.

Part Number: MAGIC-TPC-LED

Package Contents:

- Tour-Pak® Converter Harness (1)
- Cable Ties (6)
- Instructions (1)

Fits: 2014-2024 Harley-Davidson® Ultra Limited (FLHTK), 2022-2023 CVO™ Road Glide Limited (FLTRKSE), 2020-2024 Road Glide Limited (FLTRK), 2014-2019 Electra Glide Ultra Classic (FLHTCU), 2015-2016 Ultra Classic Lo (FLHTCUL) & CVO™ Road Glide Ultra (FLTRUSE), 2016-2019 Road Glide Ultra (FLTRU), 2015-2018 Ultra Limited Lo (FLHTKL), 2014-2021 CVO™ Limited (FLHTKSE), 2014-2025 Tri Glide (FLHTCUTG) and 2020-2022 CVO™ Tri Glide (FLHTCUTGSE) with OEM King Tour Pak.

Compatible only with OEM Harley-Davidson® Tour-Pak LED Side Arms



Installation:

1. Secure motorcycle on level surface.
2. Remove seat to gain access to Tour Pak® wire harness.
3. Disconnect negative battery cable from the battery.
4. Find harness connector for Tour Pak® located under the Tour Pak® along the back of passenger seat. The wiring with the connectors forms a (Y). You want to use the connector at the bottom of the (Y) and not the two at the top. (see Tour Pak® connector location)
5. Plug the MAGIC-TPC-LED male plug into the female plug of the Tour Pak® lighting harness located behind the passenger seat. Plug the female plug of the MAGIC-TPC-LED into the male plug of the Tour Pak® harness.

NOTE: If installing with a MAGIC-STROBES™ unit (sold separately) the MAGIC-TPC-LED will plug into the output side of the MAGIC-STROBES™ module.

NOTE: Review service manual for instructions for removing Tour Pak®.

CAUTION: Be sure to support the Tour Pak® lid, it will break at the hinges if it is not supported.

6. Remove (2) T15 Torx screws from Tour Pak® lid ring strap tether.

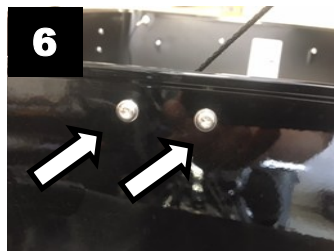

ATTENTION



Please read all Information below before Installation

Warning: Disconnect negative battery cable from battery; refer to owner's manual. Failure to do so may result in electrical shock, injury, or fire. Secure negative battery cable away from positive side of battery and all other positive voltage sources on vehicle.

Important: Confirm stock Tour-Pak operation before purchasing. Corners of stock LED Tour-Pak must function as Run/Brake/Turn, if not, the BCM may need to be reprogrammed.

Tour Pak Connector Location

For 2014-later models, the harness connector for Tour Pak® is located under the Tour Pak® along the back of passenger seat. The wiring with the connectors forms a (Y), you want to use the connector at the bottom of the (Y) and not the two at the top.



Note: Some 2016 models and all 2017-later models will not have a (y) configuration harness, there is only one 6 pin harness connector in this location, which is the correct plug for the Magic Strokes™ unit.

Installation Instructions - Page 2

7. Remove Tour Pak® liner.

CAUTION: You must continue to support the Tour Pak® lid and the Tour Pak® itself for the next several steps or you could damage the Tour Pak® or Tour Pak® lid.

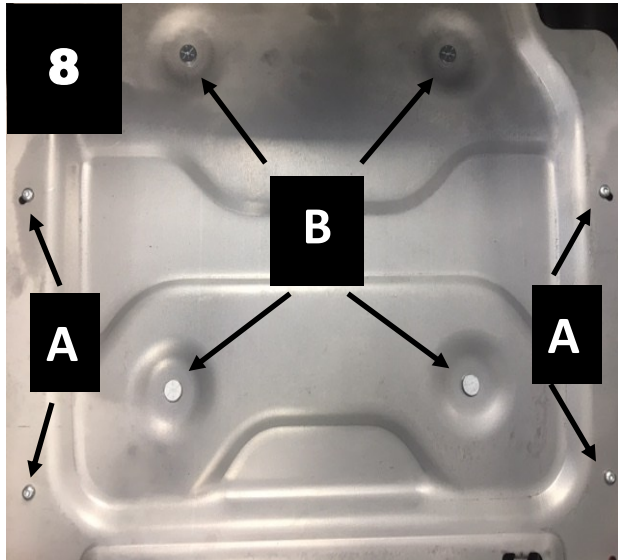

8. Remove the factory mount plate:

A. Remove (2) Torx screws for the left side and right side marker lights.

B. Remove (4) 7/16 nuts from under side of Tour Pak® mounting plate.

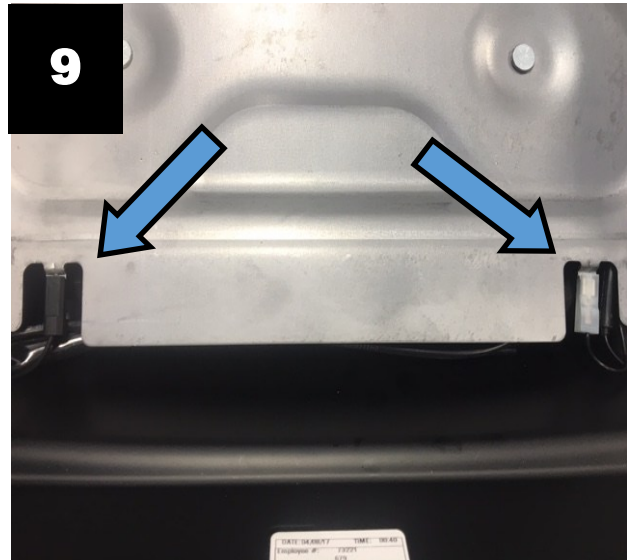

9. Remove ground wires from mounting plate .

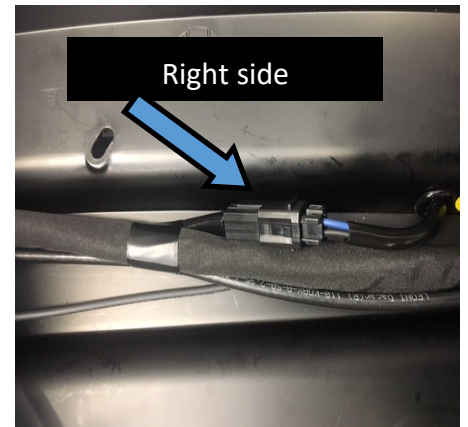
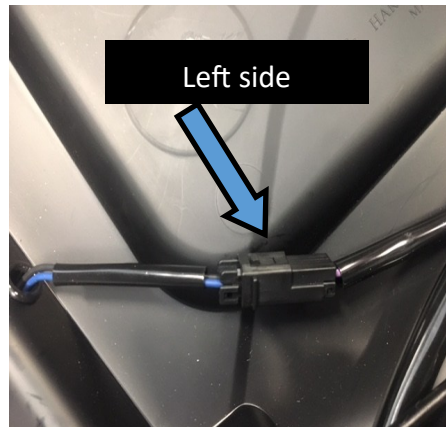
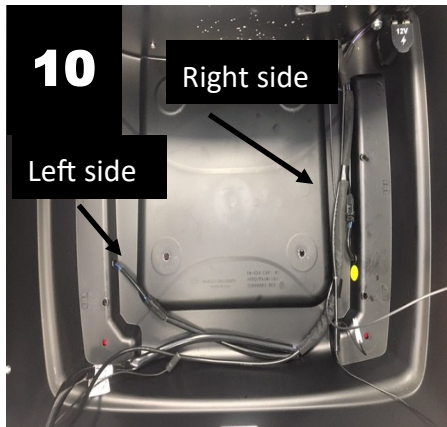

10. Disconnect 2 pin factory wire harness to the Tour Pak® lights.

Remove the 2 pin connector by pushing the center tab in and pulling the plug out.

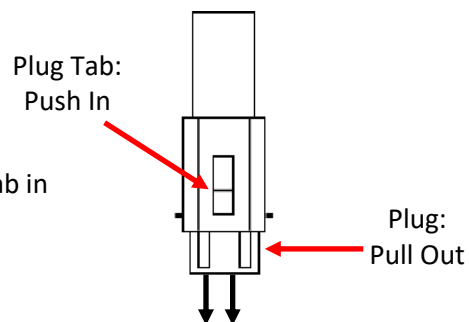

Installation Instructions - Page 3

11

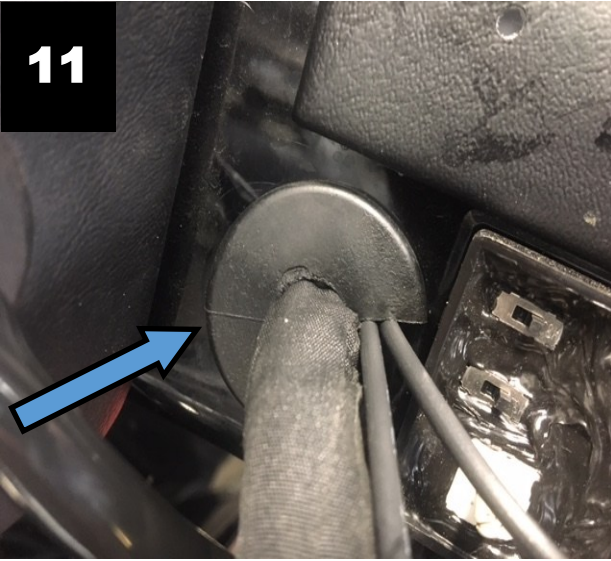

11. Remove grommet from right side of Tour Pak®. Save to re-install at a later step.

12



12. Connect the **longest** 2 wire harness with the 2 pin female plug of the MAGIC-TPC-LED to the LEFT side marker light 2 pin male plug.
13. Connect the **shortest** 2 wire harness with the 2 pin female plug of the MAGIC-TPC-LED to RIGHT side marker light 2 pin male plug

14. Install the mounting plate with the (4) 7/16 nuts and (2) Torx screws.
15. Install Tour Pak® grommet that was removed in step 11.
16. Install Tour Pak® liner.
17. Install Tour Pak® lid retaining trap tether. DO NOT OVERTIGHTEN SCREW. It will crack the Tour Pak®.
18. Test side markers lights for proper Run, Brake, and Turn operation.