



Custom Dynamics® Trike Taillight Adapter Installation Instructions

We thank you for purchasing the Custom Dynamics® Trike Taillight Adapter. Our products utilize the latest technology and high quality components to ensure you the most reliable service. We offer one of the best warranty programs in the industry and we back our products with excellent customer support, if you have questions before or during installation of this product please call Custom Dynamics® at 1(800) 382-1388.

Part Numbers: CD-TL-ADPT

Package Contents:

- Trike Taillight Adapter (1)

Fits: 2020-2021 CVO TRI-GLIDE
(FLHCUTGSE)



ATTENTION

Please read all Information below before Installation

Warning: Disconnect negative battery cable from battery; refer to owner's manual. Failure to do so may result in electrical shock, injury, or fire. Secure negative battery cable away from positive side of battery and all other positive voltage sources on vehicle.

Safety First: Always wear appropriate safety gear including safety glasses when performing any electrical work. It is highly recommended that safety glasses be worn throughout this installation process. Be sure vehicle is on level surface, secure and cool.



Installation:

1. Connect the Female connector of the TL-ADPT to the taillight Male connector. Photo 1.

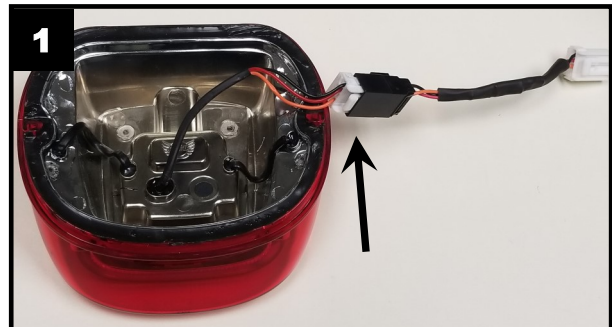

1. Connect the Male connector to the terminal block port for the taillight. Photo 2.



1. Install taillight to the taillight base.
2. Test the operation of all lighting before riding.

Questions? Call us at: 1 (800) 382-1388 M-TH 8:30AM-5:30PM / FR 9:30AM-5:30PM EST