



Custom Dynamics® Fillerz® LED Inserts Installation Instructions

We thank you for purchasing the Custom Dynamics® Fillerz® LED Inserts! Our products utilize the latest technology and high quality components to ensure you the most reliable service. We offer one of the best warranty programs in the industry and we back our products with excellent customer support, if you have questions before or during installation of this product please call Custom Dynamics® at 1(800) 382-1388.

Part Number: GEN-FDRS-RB-C

FOR EMERGENCY VEHICLES ONLY

Package Contents:

- Fillerz® LED Inserts (pair)
- Posi-Tap™ connector (4)
- 4" Cable Tie (8)
- Adhesive Primer (1)

Fits: 2014-2019 Police Model Road King® & Electra Glide® Models. Also fits 2014-2019 Electra Glide® Ultra Classic®/Low, Ultra Limited®/Low, & Road Glide® Ultra as well as 2014-2019 Limited CVO™, 2015-2016 Road Glide Ultra CVO™ and 2015 Limited CVO™ **IF** Painted Filler Panels are Removed.



Installation

1. Remove the hard bags to allow access to the fender supports on the fender.
2. Apply the provided adhesive primer onto the surface of the fender supports and allow to dry.
3. Verify Left and Right Fillerz® panels before installing. Remove the red backing from the Fillerz®. Line up the bottom edge of light with bottom edge of fender support. Push light into place until the tabs click. Apply pressure evenly over the light to ensure the tape is applied evenly.
4. Black wire to ground.
5. Red wire to 12 volts (high intensity 100% illumination).
6. Yellow wire (if used) to 12 volts (low intensity 70% illumination). Cap the end of the yellow wire if it is not used.
7. Once wiring is completed, test function.

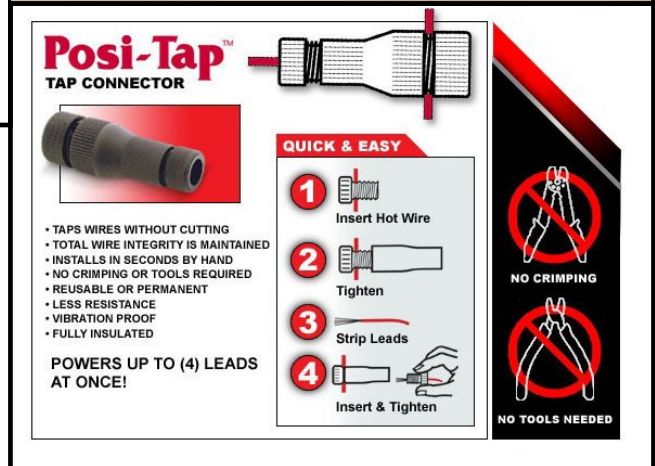

Questions? Call us at: 1 (800) 382-1388 M-TH 8:30AM-5:30PM / FR 9:30AM-5:30PM EST